



2025 Annual Graduate Research Colloquium of the Society for Modern Greek Studies information sheet

Friday 30 May 2025, University of Reading

The event is taking place in G14 Bowdidge Seminar Room, located on the ground floor of the Henley Business School building, Shinfield Road, Reading RG6 6UD.

Reading train station is a mainline train station and is easily accessible from most other places in the UK. There are direct rail links from many major cities, including Birmingham, Manchester, Glasgow, Cardiff, Bristol, and Exeter, as well as a number of routes through London.

If you are travelling from or via London, the quickest route to take is from London Paddington station, but the Elizabeth Line also connects several of London's underground stations with Reading.

If you choose to get to the University from Reading train station by bus, buses 20 and 21 come directly into Whiteknights Campus and run every 10 minutes. Tickets cost £2.50 for a single journey and £4 for an all-day pass. You can pay on the bus using a contactless bank card or smartwatch, and you can also download on your phone the [Reading Buses app](#) to pay with mobile tickets by scanning them when boarding.

The webpage below provides a useful guide on how to find the Whiteknights Campus:
<https://www.reading.ac.uk/about/visit-us>

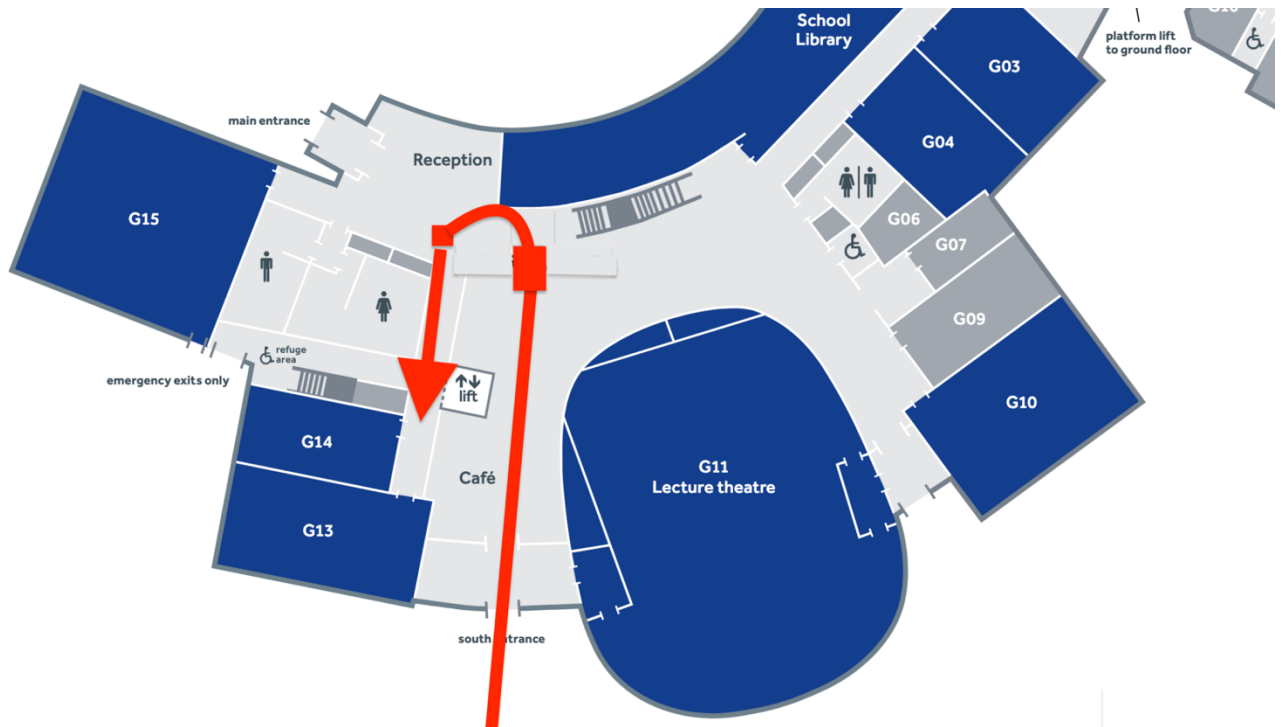

Henley Business School (HBS) has two entrances. One by the café, the South Entrance, and another near the reception, the Main Entrance. On your visit, clear signage will be visible throughout the building to direct you to G14.

Refreshments and snacks for the breaks will be provided by the Society. If you arrive early, or if you prefer to have a refreshment elsewhere, the Whiteknights Campus has several cafés, with the largest being the [Library café](#), just 3 minutes away from G14, and the nearest the [Henley Business School café](#), by the South entrance to HBS, and [Dol.che Vita](#), 2 minutes' walk from G14.

There is also a social hub, [Park Eat & Bar](#), which serves buffet-style breakfast from 8:00 am, and a Co-op supermarket 3 minutes away from G14, selling hot drinks and fresh juice, among much else.

Please remember that the University of Reading is a cashless organisation, and it only accepts card payments on campus.

To find out more about all the facilities and services offered by Whiteknights, the main campus of the University of Reading, you can follow the link below for a detailed Whiteknights campus guide:

<https://www.reading.ac.uk/ready-to-study/student-life/campus-and-facilities/whiteknights-campus>.



THE ENVIRONMENT AND GARDENS

Whiteknights is the private property of the University of Reading and visitors must adhere to University rules and regulations which are in operation throughout the University's privately owned land at Whiteknights and elsewhere.

For more information, you can download the [Whiteknights campus guide](#) which includes useful information about:

- not disturbing wildlife, picking flowers, or climbing trees
- keeping to the paths
- not removing timber or firewood, plants, bulbs, or plant material
- parking only in designated areas, where permitted to do so, and not on grass, under trees or on plantings, etc.